

Solano Community College District
Facilities Master Planning, Concept Development
FlexCal; August 10, 2012

TODAY, DESIGN WITH US!

A preview into the developing concepts of
the facilities planning at Solano CCD

Solano Community College District
Facilities Master Planning, Concept Development
FlexCal; August 10, 2012

TODAY, DESIGN WITH US!

Vacaville Center

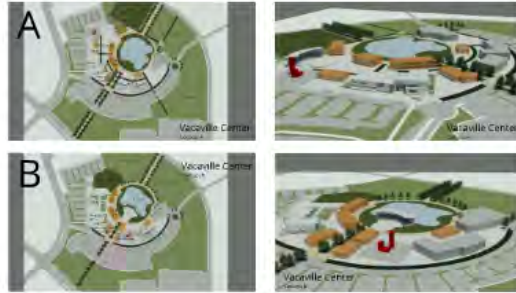

Vallejo Center



Fairfield Campus



A

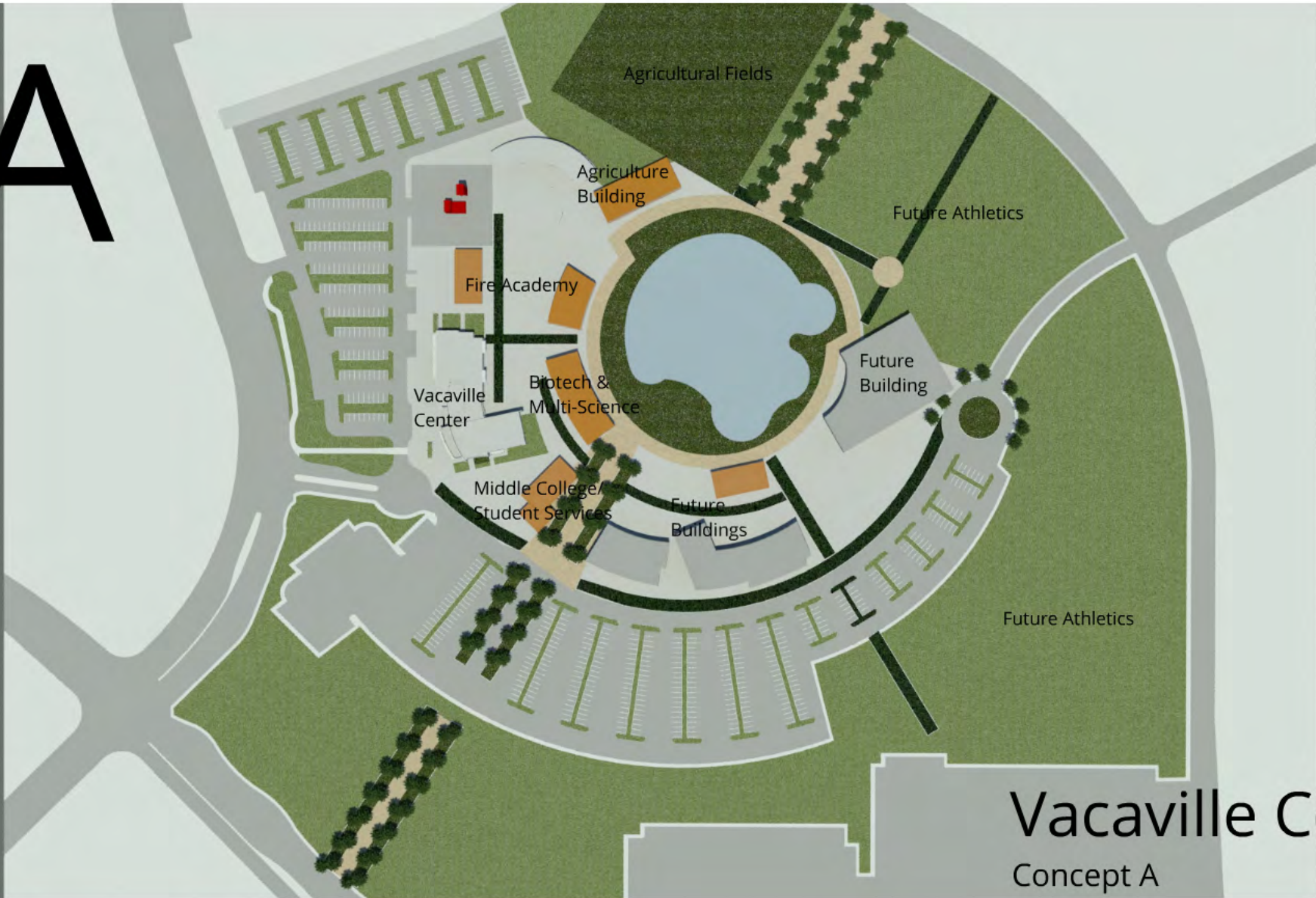

B



Vacaville Center



Vacaville Center
Concept A

B

Vacaville Center
Concept B



Vacaville Center
Concept A

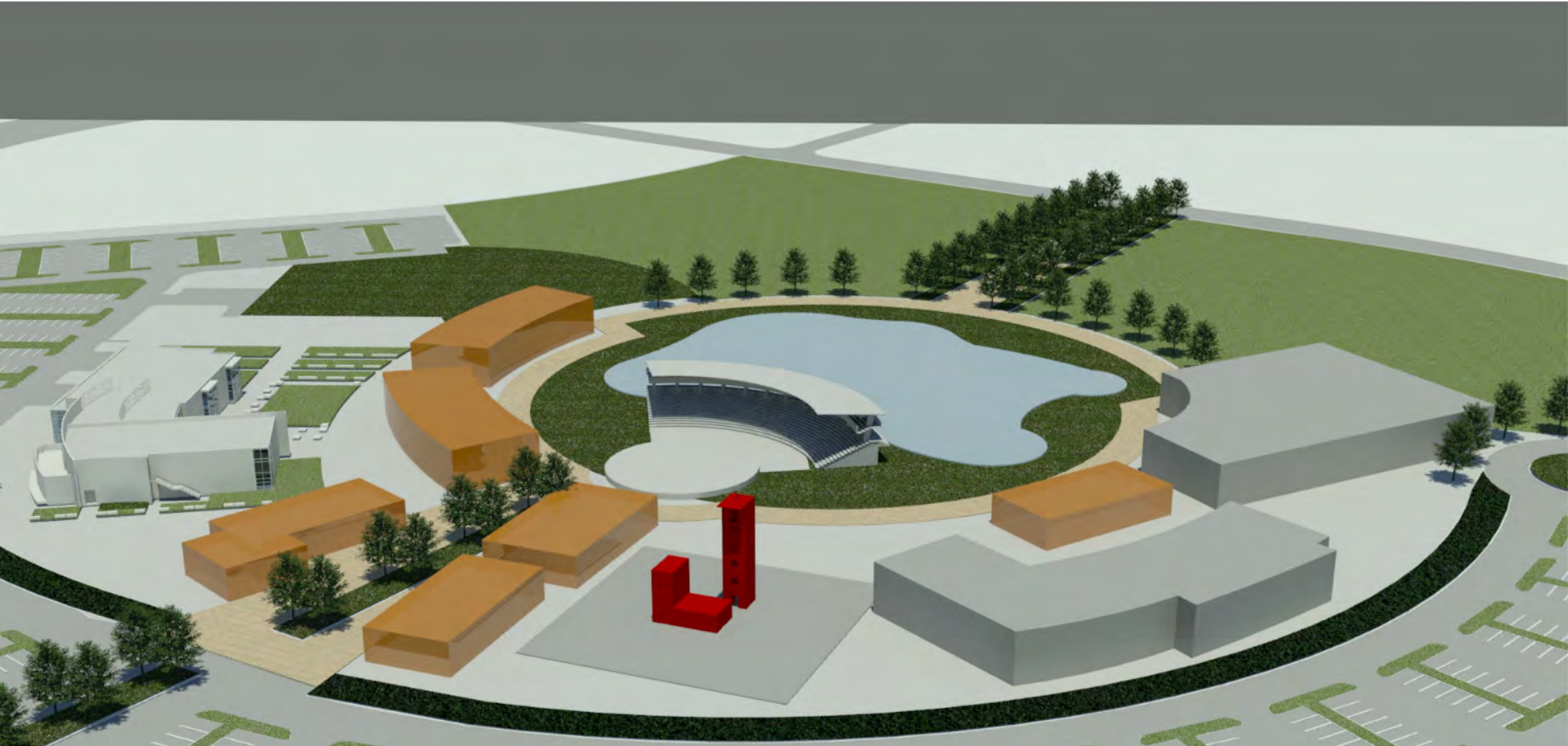

Vacaville Center
Concept B



Vacaville Center



Vallejo Center



Fairfield Campus

Fairfield Campus Traditional Quad Concept



Fairfield Campus Organic Concept



A

Vallejo Center

Concept A

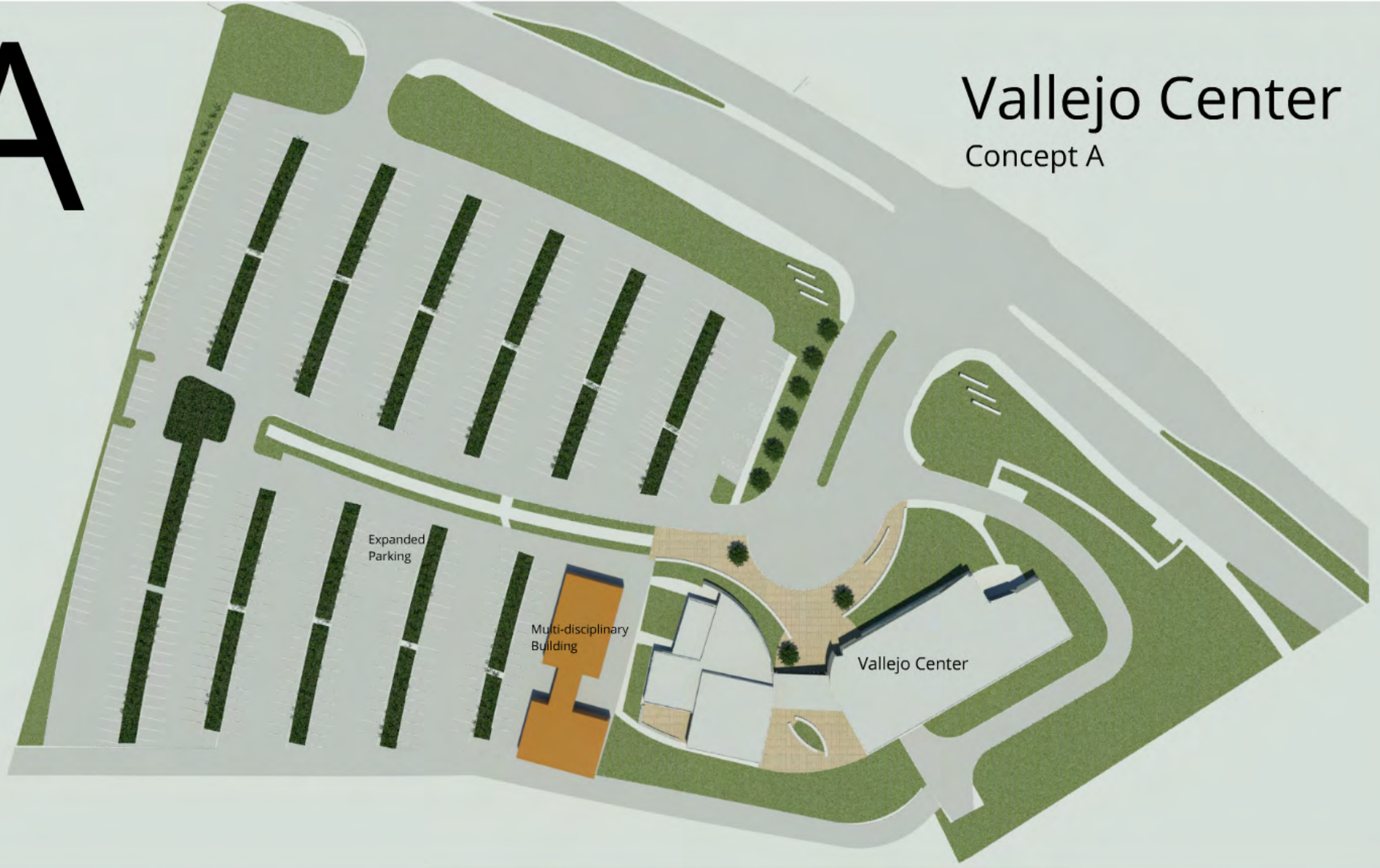

D

Vallejo Center



Vallejo Center

Concept A



Valleio Center



Vallejo Center

Concept A



Vallejo Center

B

Vallejo Center

Concept B



Vallejo Center

Concept B



Vallejo Center

Concept B



Vallejo Center



Fairfield Campus

Fairfield Campus
Traditional Quad Concept

A



Fairfield Campus
Organic Concept

B



Fairfield Campus

Traditional Quad Concept

A

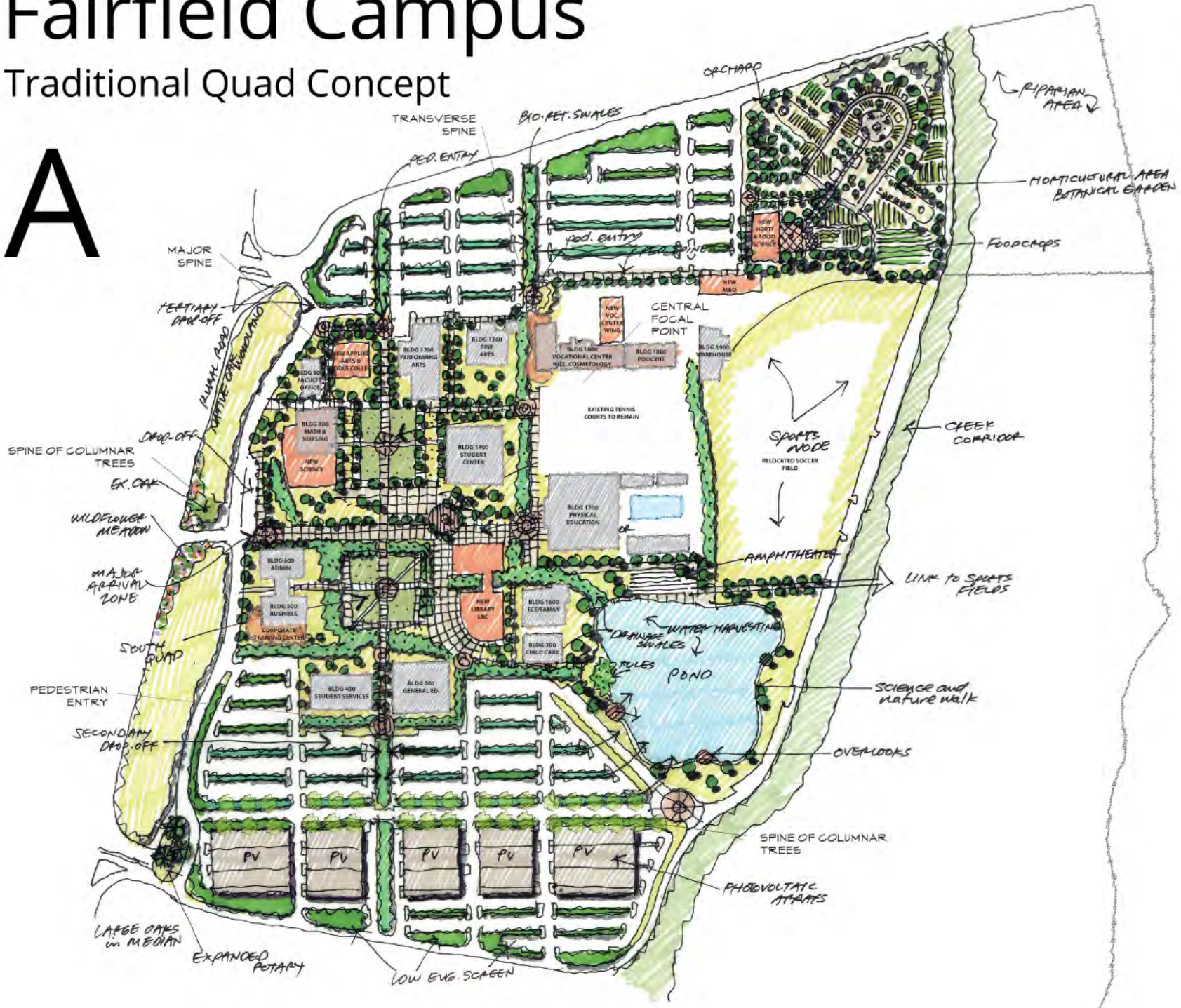

Fairfield Campus

Organic Concept

B



<p>ion: y be afforded in a new Facilities Bond ational facilities needs in alignment with the and future program and community</p>
<p>ent Renovation</p>
<p>urpose: y Facility</p>
<p>ent Renovation</p>
<p>urpose: y Facility renovation in 2026 plan</p>
<p>ent Renovation ntly Renovated Facility</p>
<p>urpose</p>
<p>urpose urpose</p>
<p>e: The above projects and square footages are final and do not reflect any decision made by Solano CCD. The list is purely for the analysis existing facilities and opportunities for ditional educational support space.</p>

27-Jul-12		"Long Range Plan" Definition: Planning beyond what may be afforded in a new Facilities Bond Program, identifying educational facilities needs in alignment with the Educational Master Plan and future program and community growth/demand.	
MAIN CAMPUS (Organic Concept)	Total Build Out - Long Range FMP Building Gross SF	Scope	Note
Main Campus EXISTING GSF	391,226		
Building 100 Library Complex	(49,600)	Demolition	
F1 New Library Learning Resource Center	59,171	New	
Building 200 Childcare Center	9,280	na	Current Renovation
F11 DEMO Building 201 Childcare #2	(1,440)	Demolition	
F2 DEMO Building 300 Science	(24,240)	Demolition	
F2 New Science & Nursing	42,400	New	
Building 400 Student Services	39,621	na	New Facility
Building 500 Business	11,616	Renovation	
F9 Corporate Training Center Addition	12,139	New	
Building 600 Administration	13,056	na	Current Renovation
F2 DEMO Building 700 Humanities	(16,864)	Demolition	
F2 DEMO Building 800	(17,856)	Retrofit	Repurpose
Building 900 Faculty Office	5,300	na	New Facility
F5 DEMO Building 1000 Horticulture	(3,977)	Demolition	Or renovation in 2026 plan
F5/F10 Horticulture/Food Science	22,829	New	
F6 RENOVATE Building 1200 Music Drama	25,231	Renovation	
Building 1300 Fine Arts	12,400	na	Current Renovation
Building 1400 Student Center	33,032	na	Recently Renovated Facility
Building 1500 Mathematics	16,417	Renovation and Small Addition	
F11 Repurposed 1600 ECE/Family	14,336	Retrofit	Repurpose
Building 1700 PE	55,881	Renovation	
F3/F4 Vocational Center & Cosmetology	12,456	New	
F3/F4 Repurpose 1800 part Vocational	13,300	Retrofit	Repurpose
F15 Repurpose 1800 part Police/IT	12,000	Retrofit	Repurpose
Building 1900 Warehouse	10,730	Renovation	
F12/13 Applied Arts & Middle College	16,000	New	
F16 M&O Complex & Storage	24,250	New	
TOTAL	347,468		
Net Difference	(43,758)	Additional	
Technology Upgrades	yes		Note: The above projects and square footages are not final and do not reflect any decision made by the Solano CCD. The list is purely for the analysis of existing facilities and opportunities for additional educational support space.
Infrastructure Upgrades	yes		
Comprehensive Storm Water Plan	yes		
Site Accessibility	yes		
Site Signage and Wayfinding	yes		
Parking revisions	yes		
Landscape renovation and replacement	yes		
New campus drive/circulation	yes		
Site Photovoltaic Panel Installations	yes		
PE Related Upgrades and Maintenance	yes		

VACAVILLE

Center EXISTING ASF
New Fire Training Facilities
Drill Tower
343 Hall
60' Ladder and Rescue Tower
International Hall
Strength & Conditioning Pavilion
Multi-Use/Science/Bio Tech Building
Student Services Bldg / Middle College
Agriculture Building
Child Care Facility
Food Café
Additional Parking
TOTAL
Net Difference
Similar Infrastructure and Site work as indicated

VALLEJO

Center EXISTING ASF
Educational Partner Building
New Student Services Center
New Child Care Facility
Food Café
Additional Parking
TOTAL
Net Difference
Similar Infrastructure and Site work as indicated

27-Jul-12					
MAIN CAMPUS (Organic Concept)	Total Build Out - Long Range FMP Building Gross SF	"Long Range Plan" Definition: Planning beyond what may be afforded in a new Facilities Bond Program, identifying educational facilities needs in alignment with the Educational Master Plan and future program and community growth/demand.			
	Main Campus EXISTING GSF	391,226	Scope	Note	
Building 100 Library Complex	(49,600)	Demolition			
F1 New Library Learning Resource Center	59,171	New			
Building 200 Childcare Center	9,280	na	Current Renovation		
F11 DEMO Building 201 Childcare #2	(1,440)	Demolition			
F2 DEMO Building 300 Science	(24,240)	Demolition			
F2 New Science & Nursing	42,400	New			
Building 400 Student Services	39,621	na	New Facility		
Building 500 Business	11,616	Renovation			
F9 Corporate Training Center Addition	12,139	New			
Building 600 Administration	13,056	na	Current Renovation		
F2 DEMO Building 700 Humanities	(16,864)	Demolition			
F2 DEMO Building 800	(17,856)	Retrofit	Repurpose		
Building 900 Faculty Office	5,300	na	New Facility		
F5 DEMO Building 1000 Horticulture	(3,977)	Demolition	Or renovation in 2026 plan		
F5/F10 Horticulture/Food Science	22,829	New			
F6 RENOVATE Building 1200 Music Drama	25,231	Renovation			
Bulding 1300 Fine Arts	12,400	na	Current Renovation		
Building 1400 Student Center	33,032	na	Recently Renovated Facility		
Bulding 1500 Mathematics	16,417	Renovation and Small Addition			
F11 Repurposed 1600 ECE/Family	14,336	Retrofit	Repurpose		
Building 1700 PE	55,881	Renovation			
F3/F4 Vocational Center & Cosmetology	12,456	New			
F3/F4 Repurpose 1800 part Vocational	13,300	Retrofit	Repurpose		
F15 Repurpose 1800 part Police/IT	12,000	Retrofit	Repurpose		
Building 1900 Warehouse	10,730	Renovation			
F12/13 Applied Arts & Middle College	16,000	New			
F16 M&O Complex & Storage	24,250	New			
TOTAL	347,468				
Net Difference	(43,758)	Additional			
Technology Upgrades	yes			Note: The above projects and square footages are not final and do not reflect any decision made by the Solano CCD. The list is purely for the analysis of existing facilities and opportunities for additional educational support space.	
Infrastructure Upgrades	yes				
Comprehensive Storm Water Plan	yes				
Site Accessibility	yes				
Site Signage and Wayfinding	yes				
Parking revisions	yes				
Landscape renovation and replacement	yes				
New campus drive/circulation	yes				

afforded in a new Facilities Bond l facilities needs in alignment with the ure program and community
renovation
ty
renovation
ty
tion in 2026 plan
renovation
renovated Facility
above projects and square footages are nd do not reflect any decision made by CCD. The list is purely for the analysis facilities and opportunities for educational support space.

VACAVILLE		Total Build Out - Long Range FMP Building Gross SF	Scope	Note
Center EXISTING ASF		36,359		
New Fire Training Facilities				
Drill Tower		2,800	New	
343 Hall		6,000	New	
60' Ladder and Rescue Tower		2,800	New	
Internaional Hall		7,500	New	
Strength & Conditioning Pavilion		1,600	New	
Multi-Use/Science/Bio Tech Building		36,000	New	
Student Services Bldg / Middle College		12,500	New	
Agriculture Building		15,000	New	Note: The above projects and square footages are not final and do not reflect any decision made by the Solano CCD. The list is purely for the analysis of existing facilities and opportunities for additional educational support space.
Child Care Facility		5,000	New	
Food Café		500	New	
Additional Parking				
TOTAL		89,700		
Net Difference		53,341	Additional	
Similar Infrastructure and Site work as indicated above for Fairfield				
VALLEJO		Total Build Out - Long Range FMP Building Gross SF	Scope	Note
Center EXISTING ASF		40,600		
Educational Partner Building		32,064	New	Note: The above projects and square footages are not final and do not reflect any decision made by the Solano CCD. The list is purely for the analysis of existing facilities and opportunities for additional educational support space.
New Student Services Center		12,500	New	
New Child Care Facility		5,000	New	
Food Café		500	New	
Additional Parking				
TOTAL		90,664		
Net Difference		50,064	Additional	
Similar Infrastructure and Site work as indicated above for Fairfield				

VACAVILLE		Total Build Out - Long Range FMP Building Gross SF	"Long Range Plan"Definition: Planning beyond what may be afforded in a new Facilities Bond Program, identifying educational facilities needs in alignment with the Educational Master Plan and future program and community growth/demand.	
Center EXISTING ASF	36,359	Scope	Note	
New Fire Training Facilities				
Drill Tower	2,800	New		
343 Hall	6,000	New		
60' Ladder and Rescue Tower	2,800	New		
Internaional Hall	7,500	New		
Strength & Conditioning Pavilion	1,600	New		
Multi-Use/Science/Bio Tech Building	36,000	New		
Student Services Bldg / Middle College	12,500	New		
Agriculture Building	15,000	New		Note: The above projects and square footages are not final and do not reflect any decision made by the Solano CCD. The list is purely for the analysis of existing facilities and opportunities for additional educational support space.
Child Care Facility	5,000	New		
Food Café	500	New		
Additional Parking				
TOTAL	89,700			
Net Difference	53,341	Additional		
Similar Infrastructure and Site work as indicated above for Fairfield				
VALLEJO		Total Build Out - Long Range FMP Building Gross SF	"Long Range Plan"Definition: Planning beyond what may be afforded in a new Facilities Bond Program, identifying educational facilities needs in alignment with the Educational Master Plan and future program and community growth/demand.	
Center EXISTING ASF	40,600	Scope	Note	
Educational Partner Building	32,064	New		
New Student Services Center	12,500	New		Note: The above projects and square footages are not final and do not reflect any decision made by the Solano CCD. The list is purely for the analysis of existing facilities and opportunities for additional educational support space.
New Child Care Facility	5,000	New		
Food Café	500	New		
Additional Parking				
TOTAL	90,664			
Net Difference	50,064	Additional		
Similar Infrastructure and Site work as indicated above for Fairfield				